



POST-TENSIONING INSTITUTE
Strength in Concrete

Member HANDBOOK

Welcome New Member
www.post-tensioning.org

Welcome to the Post-Tensioning Institute



Dear PTI Member,

Welcome to the PTI Community! As the Executive Vice President of PTI, I am excited to have you with us. Whether you are a new member or have been with us for years, your involvement in our organization strengthens our community and is truly valued.

At PTI, we pride ourselves on being the world's leading post-tensioning industry resource for technical information, standards, specifications, education, certification programs, plus marketing and promotion. Our goal is to advance the quality, safety, and sustainability of post-tensioned structures through research, education, and advocacy. Our vision continues to focus on post-tensioning being the first choice for reinforcing all structures. We are dedicated to supporting our members in their post-tensioning endeavors through a wide array of benefits.

PTI membership offers a range of benefits tailored to professional, organizational, and student members. We have designed a benefits package with your needs and interests in mind. These benefits include but are not limited to discounts on publications, conference access, technical support, industry influence, certification, and workforce development programs. The full list of benefits can be found in the pages of this handbook and on our website [here](#).

This handbook provides a comprehensive look at all the incredible resources and opportunities available to you as a PTI member. In these pages, we discuss PTI publications, certification programs, professional education resources, information about committees, and marketing guidelines and resources. Be sure to also check out the PTI Quick Reference Guide for further information. I hope that the information herein is valuable to you in your professional endeavors.

Thank you, again, for being a part of PTI. We are excited to support you on your journey and look forward to witnessing your contributions to the post-tensioning community.

Sincerely,

A handwritten signature in white ink, which appears to read 'Tim D. Christle', is positioned below the word 'Sincerely,'.

Tim D. Christle, P.E.
Executive Vice President
Post-Tensioning Institute

Content



Introduction to PTI	4
PTI Membership	5
Tonnage - Calculating Assessments	9
Publications	11
Certification Programs	13
Professional Educational Resources	23
Committees	25
Marketing	31
Additional Information: Anti-Trust Compliance	33
PTI Quick Reference Guide	34

Introduction to the Post-Tensioning Institute



Established in 1976, the [Post-Tensioning Institute \(PTI\)](#) is recognized as the worldwide authority on post-tensioning. PTI is dedicated to expanding post-tensioning applications through marketing, education, research, teamwork, and code development while advancing the quality, safety, efficiency, profitability, and use of post-tensioning systems.

Members of the Institute include major post-tensioning materials fabricators in the United States, Canada, and Mexico; manufacturers of prestressing materials in the United States, Canada, Mexico, Japan, and Europe; and companies supplying materials, services, and equipment used in post-tensioned construction.

In addition, PTI has more than 500 professional engineers, architects, and contractors. As a member of PTI, you will receive numerous benefits from all that PTI has to offer. Some categories where you will receive benefits are listed below:

- [Publications](#)
- [Certification](#)
- [Education](#)
- [Committees](#)

The specific benefits will be discussed in detail later in this handbook.



Member benefits can be found [here](#).

The various member types are as follows:

POST-TENSIONING SUPPLIER:

A PT Entity that maintains one or more locations from which it engages in one or more of the following activities:

- **Tendon Fabricator:** A PT Entity that is engaged primarily in the fabrication of unbonded, multistrand, or bar posttensioning materials.
- **Unbonded Tendon Extrusion-only Facility:** A PT Entity that is engaged only in the extrusion of sheathing on strand for unbonded single strand tendons and not in the fabrication of any other post-tensioning materials.
- **Post-Tensioning Seller:** A PT Entity that is engaged in the sale, but not the fabrication, of post-tensioning materials to any entity involved in the construction process for individual projects.

PRESTRESSING STEEL SUPPLIER

A PT Entity who maintains one or more locations from which it engages in one or more of the following activities:

- **Prestressing Steel Manufacturer:** A PT Entity that is engaged in the manufacture of prestressing strand, bar or wire used by those eligible for Post-Tensioning Supplier Membership.
- **Prestressing Seller:** A PT Entity that is engaged in the sale of prestressing strand, bar or wire to any entity eligible for Post-Tensioning Supplier Membership.

ASSOCIATE

A PT Entity that is engaged in the manufacture and/or sale of equipment or other materials used by those eligible for Post-Tensioning Supplier Membership.

AFFILIATE

A PT Entity that is engaged in the supply of services to those eligible for Post-Tensioning Supplier Membership, such as but not limited to software, and other non-hardware based technologies. Resellers of the Institute's publications shall also be Affiliate Members.

CONTRACTOR COMPANY

A PT Entity that contracts with another person, firm, partnership, corporation, company or organization for the construction of a slab-on-ground building, bridge or other structure in which post-tensioning is used, or that is engaged in the installation or stressing of post-tensioning materials.

CONSULTING COMPANY

A PT Entity that is engaged in providing professional consulting services to the Institute, its Members, their customers, or the post-tensioning industry.

INTERNATIONAL ORGANIZATIONAL-LEVEL MEMBER

A PT Entity that does not qualify for North American Organizational-Level member status as defined in Article III, Section 5.1 hereof.

- ***International Post-Tensions Supplier***
- ***International Prestressing Steel Supplier***
- ***International Associate***
- ***International Consulting Company***
- ***International Contractor Company***
- ***International Affiliate***

TRADE ASSOCIATION

Any trade association or organization having United States income tax exemption or having purposes and objectives compatible with the goals and purposes of the Institute.

PROFESSIONAL MEMBER

An individual who meets one or more of the following qualifications, or who is deemed by the Institute to have abilities or standing equal to one or more of these qualifications:

Design Professional:

- **Licensed Design Professional:** *An individual who is licensed to practice structural design or architecture.*
- **Engineers- and Architects-in-Training:** *An individual who is a graduate of a recognized institution of higher learning, in the field of architecture or engineering, but who has not yet fulfilled the requirements for professional licensing.*

Construction Professional:

- **Contractor/Builder:** *An individual who is employed by a firm, or corporation that contracts with another organization or individual for the construction of a building, bridge or other structure in which posttensioning is used, or that is engaged in the installation or stressing of post-tensioning materials.*
- **Construction Engineer/Construction Manager:** *An individual who plans, manages and/ or inspects construction projects.*
- **Inspector/Testing Technician:** *An individual who performs inspection and/or testing related to post-tensioning systems or post-tensioned construction.*

Government Employee: *An individual who is employed by federal, state or local government.*

Academic:

- **Educator:** *An individual who is employed full-time as a professor/ instructor in a recognized institution of higher learning, in the architectural, engineering or construction management field.*
- **Student:** *An individual who is enrolled fulltime in a recognized institution of higher learning, in the architectural, engineering or construction management field.*

Other Professional Services:

- **Legal Professional:** *An attorney or other legal professional who advises or represents the Institute, its Members, their customers or the Post-Tensioning Industry in legal matters.*
- **Information Technology Consultant:** *An individual who provides consulting services related to computer systems and applications to the Institute, its Members, their customers or the Post-Tensioning industry.*
- **Researcher/Scientist:** *An individual who is possesses a degree from a recognized institution of higher learning in the field of science, including: physics, chemistry, and geology, and who performs services for the Institute, its Members, their customers or the Post-Tensioning industry.*

Organizational, Professional, and Student member benefits can be found [here](#).

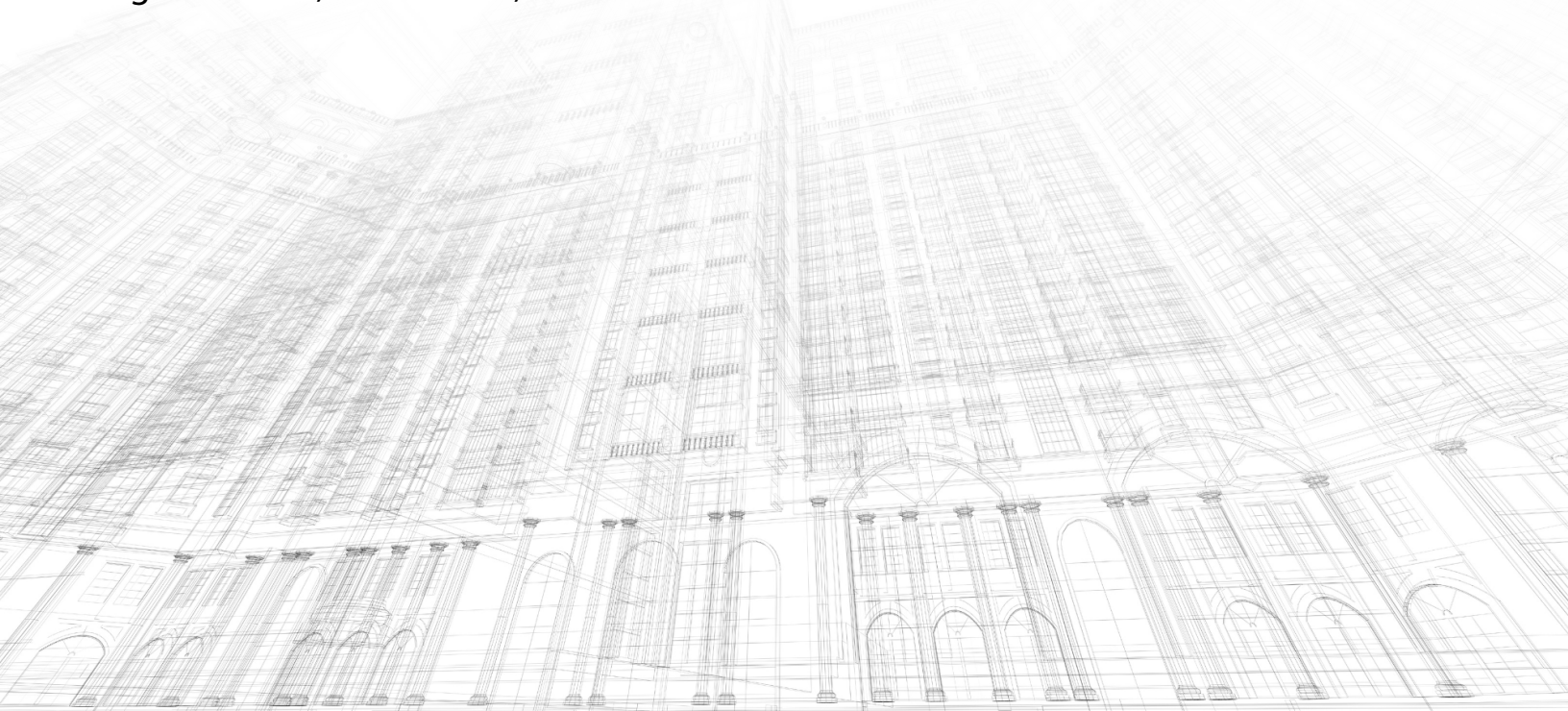

All participating plants in the PTI Unbonded Tendon Plant Certification Program, as a condition of certification, must pay a fee based on total North American shipments of post-tensioning materials, including coated, unfabricated strand. Tonnage reports must be sent to PTI at the end of each quarter. These reports are used to determine tonnage assessments and to compile PTI's annual tonnage report. Note: all individual company tonnage reports are kept strictly confidential and are only reported collectively with other industry members. Shortly after the end of each calendar quarter, PTI sends participating plants a reminder and a reporting form. Reports should conform to the following:

- Tonnage should be broken down according to the market categories and regions on the included sample tonnage form and map:

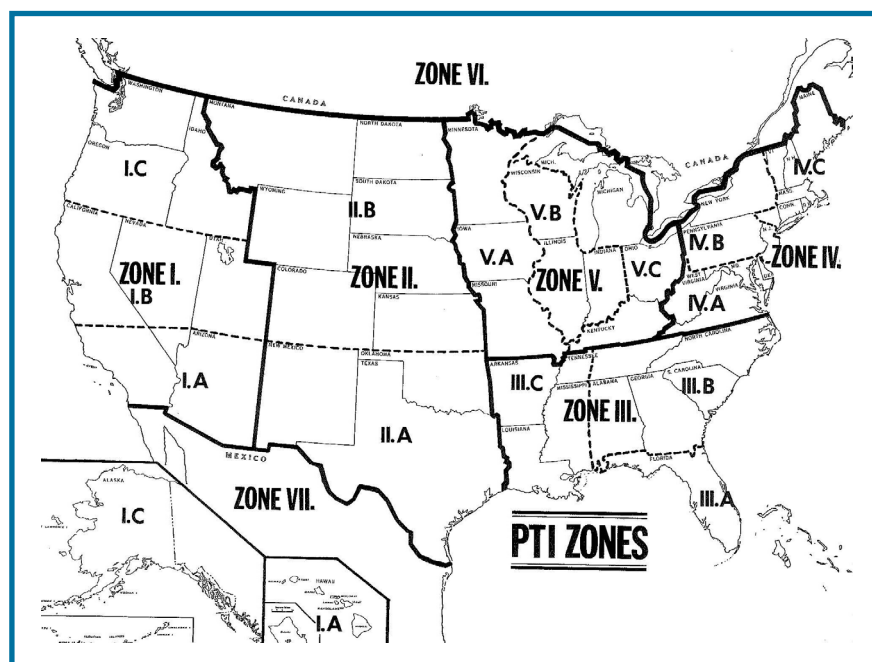

- The tonnage fee for tonnage shipped outside the United States but within North America should be 50% of the United States tonnage assessment rate calculated in U.S. dollars. This provision is applicable to all individual companies, including those located outside of the United States, or to calculation of consolidated tonnage assessments for separate companies wholly or majority owned by the same parent company.

Tonnage – Continued



- Payment of the tonnage fee is only required once on all shipments of post-tensioning materials. For coated unfabricated strand shipped between participating plants in the Unbonded Tendon Plant Certification Program, the participating plant fabricating the completed post-tensioning assembly should report the tonnage to PTI and shall be responsible for payment of the tonnage fee to PTI.
- When one or more post-tensioning suppliers are wholly or majority owned by the same parent entity, the total shipments of post-tensioning materials of both or all companies so owned should be utilized in calculating the tonnage fee for each such entity.

Tonnage reports are due to the PTI office no later than 60 days after the close of the quarter. Upon receipt of the report, PTI will issue an invoice for the corresponding tonnage assessment in accordance with the applicable tonnage rate established by the Board of Directors. Payment of the tonnage fees is expected within 60 days of the invoice date.



**POST-TENSIONING
INSTITUTE®**
Strength in Concrete

Summary of Tonnage Reports for the Year _____

_____ Quarter

Zone	Market					Total
	Buildings	Bridges	Earthwork	S-O-G	Misc.	
IA (AZ/S,CA/S,NV)						0
IB (N,CA/N,NV/UT)						0
IC (AK,WA,OR,ID)						0
Hawaii						0
IIA (NM, OK, TX)						0
IIB (CO,KS,WY,NE,MT,ND,SD)						0
IIIA (FL)						0
IIIB (AL,GA,NC,SC, E,TN)						0
IIIC (AR,LA,MS, W,TN)						0
IVA (DE,MD,VA,WV,DC)						0
IVB (S,NJ,NY,PA)						0
IVC (CT,MA,ME,N,NJ,NH,RJ,VT)						0
VA (IA,MN,MO)						0
VB (IL,IN,WI)						0
VC (KY,MI,OH)						0
Canada VI						0
Mexico VII						0
Total	0	0	0	0	0	0

Rate: \$2.25/ton

Company: _____

Completed by: _____

Date: _____

One of PTI's principal functions is to provide technical guidance on the design, construction, maintenance, and repair/rehabilitation of post-tensioned concrete structures. PTI has published over 30 informative manuals and technical guides covering most aspects of post-tensioning. In addition, PTI publishes a technical journal, newsletters, Technical Notes, Frequently Asked Questions, and Technical Updates, which give an in-depth discussion and analysis of issues pertinent to designers in the post-tensioning field.

Most PTI publications are available in both printed hard-copy and digital formats. Printed hard-copy publications are shipped free within the United States. Digital editions are intended for use by a single user only and have been protected against unauthorized distribution using a proprietary Digital Rights Management (DRM) technology.

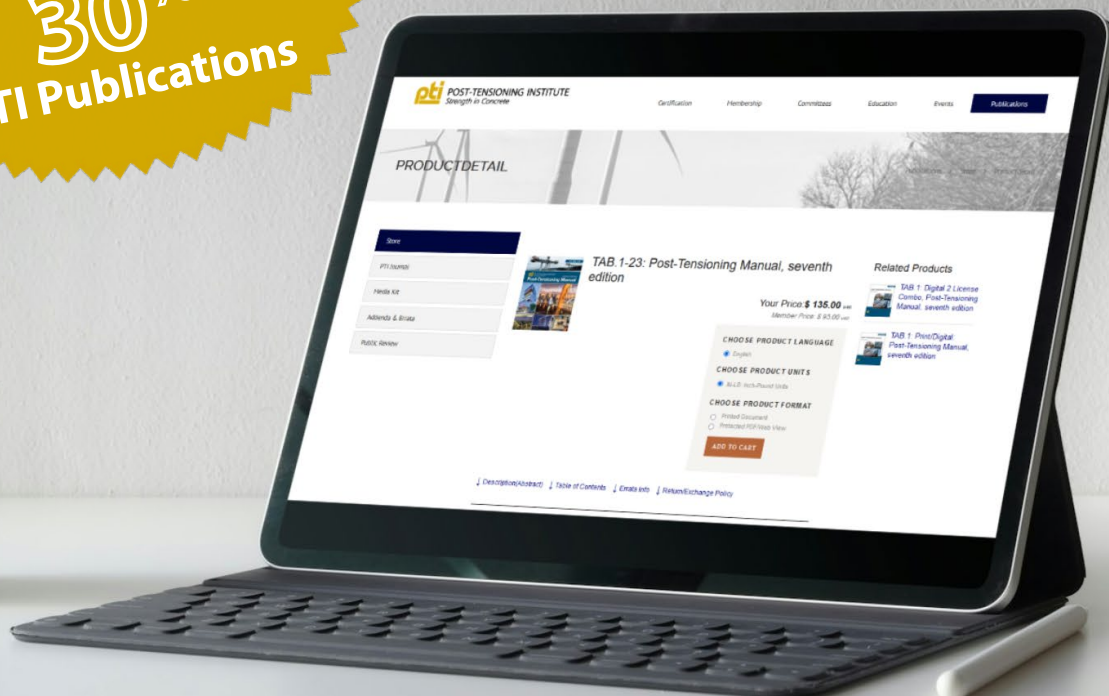

Information regarding digital publications is listed below:

ELECTRONIC/DIGITAL PUBLICATIONS

Digital publications are intended for use by a single user only and have been protected against unauthorized distribution using a proprietary Digital Rights Management (DRM). PTI digital publications will only work with Adobe Acrobat or Adobe Reader.

Single-User License:

- *Allows the files to be viewed only on the computer on which the license is activated (other computers on a network will not be able to view the files unless additional licenses are purchased).*

Optional 2nd Installation License:

- *Allows the files to be viewed only on the computer on which the license is activated (other computers on a network will not be able to view the files unless additional licenses are purchased).*

Print Digital Publications:

- *Two print copies are allowed.*
**Note: The number of copies is related to the number of print jobs and not the number of pages a user prints, whether it be one page or the entire document.*

These are not eligible for a return/refund.



One of the goals of the Institute is to ensure that specifiers and purchasers of post-tensioning materials receive products and services that meet a recognized standard of quality. Working toward this goal, PTI has established certification programs both for manufacturing plants and for field personnel.

MANUFACTURING PLANTS CERTIFICATION PROGRAM

Certification of Plants Producing Unbonded Single-Strand Tendons (Certification Process):

Launched in 1989, the PTI program for Certification of Plants Producing Unbonded Single-Strand Tendons has been developed to provide independent certification of a plant's extrusion and/or fabrication process and its capability to produce standard and/or encapsulated unbonded single-strand tendons. This certification program also includes evaluation of calibration practices for jacks and gauges used for stressing single-strand tendons. The program is applicable to all facilities whether fixed or mobile.

The certification of a plant under this program indicates that the plant and the personnel are capable of producing unbonded single-strand tendons in conformance with the Post-Tensioning Institute's Specification for Unbonded Single-Strand Tendons. The certification program extends only to the process for extrusion and/or fabrication procedures and materials within the examined plant and is expressly not intended to cover procedures or events subsequent to the shipment of tendons to the job site.



Certification Programs – Continued



FIELD PERSONNEL CERTIFICATION PROGRAMS:

PTI offers six training and certification workshops for field personnel shown to comply with the requirements of IBC, ACI 318, and ACI 301. Proper knowledge-based training of the personnel involved in post-tensioning field operations—installers, inspectors, engineers, and others—is vital to ensuring the performance, serviceability, durability, and safety of post-tensioned concrete construction.

LEVEL 1 UNBONDED PT INSTALLATION

This two-day workshop outlines the basic body of knowledge that should be possessed by all personnel involved in the installation of single-strand unbonded post-tensioning (PT) systems **for elevated structures**. It also serves as an effective introduction for personnel new to post-tensioning, while at the same time providing support and organization for experienced persons. The course and study manual are also offered in Spanish.

Certification Requirements:

- Workshop attendance
- Exam minimum score: 70%
- Work experience: none



LEVEL 1 & 2 UNBONDED PT INSTALLER & INSPECTOR

This three-day workshop outlines the body of knowledge that should be possessed by all personnel involved in the installation and inspection of single-strand unbonded post-tensioning systems **for elevated structures**. Introduced in 2019, this workshop includes a field demonstration which includes the assembly of an elevated slab with discussion between the installers and inspectors on the key elements to a successful project (the field demo is typically offered at PTI-organized workshops).

This model is designed to reduce travel expense and allow installers, building officials, engineers, and industry personnel to obtain Level 2 Unbonded PT Installer or Inspector certification. This workshop enhances the knowledge and capabilities of installers, inspectors, and other key personnel involved in the field inspection of single-strand unbonded post-tensioning systems. The course and some study materials are also offered in Spanish.



Certification Requirements for Level 1 Unbonded PT – Field Installation:

- Workshop attendance
- Exam minimum score: 70%
- Work experience: none
- If someone already holds a Level 1 Unbonded PT Field Installation Certification, the passing score of minimum 70% constitutes renewal

Requirements Continued on Next Page

Certification Programs – Continued



LEVEL 1 & 2 UNBONDED PT INSTALLER & INSPECTOR – CONTINUED

Certification Requirements for Level 2 Unbonded PT Installer or Inspector:

- Workshop attendance
- Exam minimum score: 80%
- Work experience: 500 hours
- Working in elevated PT construction
- Minimum 150 hours of installation or inspection of installation
- Minimum 150 hours of stressing or inspection of stressing



Certification Programs – Continued



LEVEL 1 & 2 UNBONDED PT REPAIR, REHABILITATION & STRENGTHENING

This workshop enhances the knowledge and capabilities of installers and inspectors and other key personnel involved in the repair, rehabilitation, and strengthening of single-strand unbonded post-tensioning systems for elevated structures. This comprehensive workshop requires that the individuals in the workshop have current PTI certification for installation and stressing of single-strand unbonded tendons for elevated construction together with field work experience in the installation and stressing of unbonded tendons.

Certification Requirements for Level 1 PT Repair:

- Current Certification Level 1 Unbonded PT Installation, or Current Certification Level 2 Unbonded PT Installer or Inspector
- Workshop attendance
- Exam minimum score: 70%
- Work experience: none

Requirements Continued on Next Page



LEVEL 1 & 2 UNBONDED PT REPAIR, REHABILITATION & STRENGTHENING – CONTINUED

Certification Requirements for Level 2 PT Repair:

- Current Certification Level 1 Unbonded PT Installation, or Current Certification Level 2 Unbonded PT Installer or Inspector
- Workshop attendance
- Exam minimum score: 80%
- Work experience: if someone holds a current Level 1 Unbonded PT Installation Certification, 800 total hours of Installation or Inspection of Unbonded PT work on elevated structures (minimum 150 in repair installation and minimum 150 in repair stressing is required.)
- If someone holds a current Level 2 Unbonded PT Installer or Inspect or Certification, 300 total hours of Installation or Inspection of Unbonded PT work on elevated structures (minimum 150 in repair installation and minimum 150 in repair stressing is required.)



Certification Programs – Continued



LEVEL 1 & 2 SLAB-ON-GROUND INSTALLER & INSPECTOR

This two-day workshop is designed specifically for the installation and inspection of single-strand unbonded post-tensioning systems for residential and light commercial slabs-on-ground. It outlines the basic body of knowledge that should be possessed by all personnel involved in the installation and stressing of PT in these light foundation systems.



Certification requirements for Level 1 PT Slab-on-Ground – Field Installation:

- Workshop attendance
- Exam minimum score: 70% (If someone already holds Level 1 unbonded PT slab-on-ground certification, a passing score of a minimum of 70% constitutes a renewal)
- Work experience: none

Certification Requirements for Level 2 PT Slab-On-Ground:

- Workshop attendance
- Exam minimum score: 80%
- Work experience: 500 hours working in unbonded PT slab-on-ground (minimum 150 hours of installation or inspection of installation. Minimum 150 hours of stressing or inspection of stressing).



Certification Programs – Continued



LEVEL 1 & 2 MULTISTRAND & GROUTED PT SPECIALIST

This comprehensive three-day workshop covers the installation of multistrand and bar PT systems, procedures including safety, as well as grout materials, testing, and grouting techniques **for multistrand applications**. The equipment used for the various steps is also addressed.

This workshop includes a field demonstration which includes grout testing a small sample of different grouts, display and discussion of stressing and grouting equipment operations, and display and discussion of different multistrand and bar PT components.

Certification Requirements for Level 1 Multistrand & Grouted PT–Field Installation:

- Workshop attendance
- Exam minimum score: 70%
- Work experience: none

Certification Requirements for Level 2 Multistrand & Grouted PT–Field Specialist:

- Workshop attendance
- Exam minimum score: 80%
- Work experience: 1,500 hours (minimum 250 hours in installation, minimum 250 hours in stressing, and minimum 250 hours in grouting. inspection of multistrand and grouted PT work in three categories also accepted).



Certification Programs – Continued



LEVEL 1 & 2 MULTISTRAND & GROUTED PT INSPECTOR

This workshop is a one-day workshop designed to certify Multistrand & Grouted PT Inspectors. This workshop enhances the knowledge and capabilities of individuals involved in the inspection of multistrand and bonded post-tensioning systems **for multistrand applications**.

Certification requirements for Level 1 Multistrand Inspector:

- Current certification Level 1 Multistrand & Grouted PT Installation, or current certification Level 2 Multistrand & Grouted PT Specialist
- Workshop attendance
- Exam minimum score: 70%
- Work experience: none

Certification Requirements for Level 2 Multistrand Inspector:

- Current certification Level 1 Multistrand & Grouted PT Installation, or current certification Level 2 Multistrand & Grouted PT Specialist
- Workshop attendance
- Exam minimum score: 80%
- Work experience: 500 hours, minimum 100 hours in installation inspection, minimum 100 hours in stressing inspection, and minimum 100 hours in grouting inspection



Certification Programs – Continued



RENEWALS

PTI offers renewal of your PTI field certification; field personnel certifications expires four years after the date of the exam and must be kept current by successful completion of a renewal exam and re-submittal of continuing work experience (if applicable). PTI has all field certification programs available for renewal online. Most exams are offered in English and Spanish.

RE-TAKES

PTI offers exam re-takes for your PTI field certification in the instance that you fail to pass any exam. Available both in person and online, a maximum of two re-takes is allowed within a year of attempting your first exam of a certification workshop. Failure to pass two re-take exams and receive a certification requires a re-take of the full PTI workshop again. Most exams are offered in English and Spanish.



PTI offers several resources for both practicing professionals and students geared to engineering, architecture, and construction management, as explained further below.

The Institute holds several seminars, webinars, and workshops each year along with providing technical sessions at the PTI Convention. These training opportunities focus on a wide variety of post-tensioning applications. Additionally, PTI offers professional development hours (PDH) to assist professionals in achieving their continuing education objectives.

DESIGN SEMINARS

PTI offers special request educational seminars related to the design and construction of post-tensioned structures. The seminars are a half day or a full day in length and provides attendees with the latest PT design and construction techniques from experienced design professionals.



MONTHLY WEBINARS

The PTI monthly webinars program is an important part of the educational initiative of PTI. Each month a new industry topic is presented in a live webinar format, and then these presentations are made available for on-demand learning in the PTI Academy portion of the PTI website. PDHs can be earned via either attendance option.

Professional Educational Resources – Continued



CERTIFICATION WORKSHOPS

PTI offers several certification and training programs in which professionals can enhance their knowledge of bonded multistrand and unbonded post-tensioning field installation, inspection, repair, and construction. Attendees can also take advantage of this training to advance their professional development.



PTI CONVENTION

The annual PTI Convention is an excellent opportunity for practicing professionals to expand their knowledge of post-tensioning and to network with other practitioners. The Convention features three days of technical sessions with presentations on a wide variety of post-tensioning design and construction topics.



In addition, a concurrent exhibition of industry suppliers showcases the latest in post-tensioning services and products. Convention attendees have an opportunity to earn PDHs when they attend these technical sessions, as well as when they attend technical and certification committee meetings.

PTI Committees are crucial for advancing standards, safety, and innovation in construction practices. Networking with professionals already involved in the field can provide valuable insights and potential connections to join such a committee. PTI committees are open to all members and are instrumental in provide guidance to practitioners and in advancing industry practices.

JOIN A PTI TECHNICAL OR CERTIFICATION COMMITTEE

Voting members of PTI technical and certification committees are essential to the development of PTI's programs, standards, and documents. Contribute your knowledge and expertise by joining a PTI Committee. Complete the [online form](#) to apply for the committee of your choice.

Committee members are expected to contribute technical information, return ballots promptly, comment on draft reports, and attend at least one committee meeting a year.



BOARD AND BOARD LEVEL COMMITTEES

BD-100: Board of Directors

The PTI Board of Directors shall be responsible for the management and control of the Institute and its affairs. The Board shall be composed of one (1) director for each Post-Tensioning Member of the Institute, two (2) directors representing Prestressing Steel Supplier Members, two (2) directors representing Associate Members, one (1) director representing Consulting Company Members, one (1) director representing Installing Company Members, one (1) director representing Affiliate Members, three (3) directors representing Professional Members, one (1) director-at-large and the Officers of the Institute other than the Executive Director.

EX-105: Executive Committee

The Board of Directors may annually elect from its members an Executive Committee of nine (9) members, consisting of the President, Past President, Vice President, Secretary, and four (4) other directors, one (1) of whom shall be a representative of Post-Tensioning Company Members, one (1) of whom shall be a representative of Prestressing Steel Supplier Members, one (1) of whom shall be a representative of Associate Members, one (1) of whom shall be a representative of Professional Members, and the Executive Director. The Executive Committee, during intervals between meetings of the Board of Directors, shall possess and may exercise all the powers of the Board of Directors in the management and direction of the affairs of the Institute. The Executive Committee shall also perform such other duties as may from time to time be delegated to it by the Board of Directors. The terms of office of the Executive committee shall expire at the end of a calendar year.

FAC-100: Finance Advisory Committee

Mission Statement Unavailable.

EDC-130: Education Committee

Mission Statement Unavailable.

Committees – Continued



MBR-160: Membership Committee

The PTI Membership Committee is charged with providing guidance to the PTI Board and staff on membership programs, value (to include dues) and resources.

MKT-150: Marketing Committee

Promote the Post-Tensioning Institute (PTI) and the design, use and inherent advantages of post-tensioning systems through a comprehensive marketing program.

CERTIFICATION COMMITTEES

CRT-140: Certification Advisory Board (CAB)

Initiate, develop, implement, and oversee the individual, plant, and product certification programs of the Post-Tensioning Institute.

CRT-20: Unbonded Tendon Plant Certification Committee

Develop and oversee a certification program for plants producing unbonded tendons.

CRT-30: Unbonded PT Personnel Committee

Initiate, develop, implement, and oversee field personnel certification programs of the Post-Tensioning Institute.

CRT-40: Multistrand & Grouted PT Personnel Committee

Mission Statement Unavailable.

CRT-60: Unbonded PT Repair, Rehabilitation and Strengthening Field Personnel Committee

Initiate, develop, implement, and oversee the Post-Tensioning Institute certification program for Field Personnel performing Repair, Rehabilitation and Strengthening of post-tensioned structures.

CRT-70: PT Systems Qualification Testing and Certification Committee

Develop a standardized approval process and oversee an independent certification program for Post-tensioning Systems (PTS) per PTI/ASBI M50.3.

TECHNICAL COMMITTEES

TAB-120: Technical Advisory Board (TAB)

The Technical Advisory Board is responsible for all technical and research activities of the Institute, including all publications and promotional material with technical content; it provides a continuous flow of current and pertinent information to the professional membership of the Institute.

RD-100: Research & Development Committee

Mission Statement Unavailable.

DC-10: Slab-on-Ground Committee

Develop and report information on design and construction of post-tensioned slab-on-ground foundations. Develop and maintain standard requirements for analysis and design of slab-on-ground foundations on expansive soils.

DC-20: Building Design Committee

Develop and report information on the design of post-tensioned buildings.

- **DC-20A: BIM Subcommittee**

To develop and report information on the application of building information modeling to post-tensioned structures.

DC-25: Parking Structure Committee

Develop and communicate information on the costs, design, construction and advantages of post-tensioning to make it the option of choice for parking structures.

DC-35: Prestressed Rock and Soil Anchor Committee

Develop and report information on the design and construction of prestressed rock and soil anchors.

DC-40: PTI/ASBI Bridge Design Committee

Develop, report, and maintain information on post-tensioned concrete bridges.

DC-45: Cable-Stayed Bridge Committee

To present recommendations for the design, installation, and testing of stay cables members and to supplement the provisions of the AASHTO LRFD Bridge Design and Construction Specifications as they relate to the use of stay cables in bridges.

DC-80: Repair, Rehabilitation & Strengthening Committee

Develop and report information on the evaluation, repair, rehabilitation and strengthening of post-tensioned structures.

M-10: Unbonded Tendon Committee

Develop and report information on, and maintain specifications for, post-tensioned concrete structures with unbonded tendons.

M-50: PTI/ASBI Bonded Tendon Joint Task Group

Develop and maintain specifications for multistrand and high strength bar post-tensioning systems, used with bonded and unbonded tendons.

- ***M-50A: Flexible Filler Subcommittee***

Mission Statement Unavailable

M-55: Grouting Committee

Develop and report information on grouting procedures and practices for post-tensioning. Maintain PTI Specification M55.1, Specification for Grouting of Post-Tensioned Structures.



PTI is dedicated to advancing the use of post-tensioning in various applications through strategic initiatives in marketing, education, research, collaboration, and code development. Within PTI, the [Marketing Committee \(PTI MKT-150\)](#) has devised a comprehensive plan with the following objectives:

- Position the post-tensioning industry and post-tensioning as the first choice for reinforcing all structures.
- Reinforce PTI as the leading post-tensioning resource for technical expertise, standards, specifications, education, and certification.
- Establish PTI's brand guidelines for consistent marketing and published materials.

To achieve these goals, the committee targets engineers, design professionals, contractors, consultants, educators, and other stakeholders in the post-tensioning industry through diverse marketing channels:

CERTIFICATION WEEKS

Exclusive workshops providing training and certification opportunities for post-tensioning field personnel, including installers, inspectors, and engineers, held in seven cities across the United States.



WORLD OF CONCRETE (WOC)

PTI serves as a co-sponsor of this premier international event for concrete and masonry professionals, providing access to cutting-edge equipment, products, training, and technology to enhance project performance and safety.

PTI CONVENTION

This primary event focusing on post-tensioned concrete in structures and slabs brings together industry professionals and companies for five days of committee meetings, technical sessions, networking opportunities, and exhibitions.



PTI COMMITTEE DAYS

A scaled-down event from Convention, this event gathers active and influential professionals from the industry, providing insights into technological advancements, research findings, and innovative ideas shaping the industry.

PTI MEMBERSHIP DIRECTORY

An annual publication containing contact details of all PTI Members, serving as a valuable resource for industry professionals.

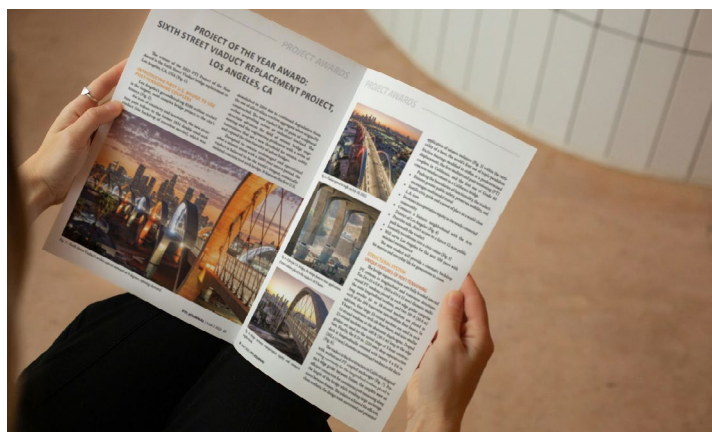

PTI JOURNAL

A biannual publication distributed to PTI Members worldwide, featuring peer-reviewed technical papers, articles, industry news, and case studies, providing enduring brand exposure. This publication available purchase by non-members on the PTI website and is distributed at major industry events.

ANTI-TRUST COMPLIANCE

A free exchange of ideas on matters of mutual interest to the members is necessary for the success of all meetings. Indeed, such an exchange of views is essential to the successful operation of every trade association. However, certain areas of communication between competitors or between manufacturers and their suppliers and customers must be avoided, as posing potential antitrust problems.

PTI is committed to ensuring that its members comply with all applicable antitrust laws and regulations. To this end, PTI has adopted its [“Policy Statement on Compliance with Antitrust Laws”](#) that sets forth guidance for members in conjunction with all activities within the scope of, and related to, the official functions of PTI.



GENERAL

- Home Page
- Staff Directory
- Technical Question
- Marketing Opportunities

CERTIFICATION

- Personnel Certification Overview
- Unbonded PT Workshops
- Multistrand & Grouted Workshops
- Find Certified Personnel
- Certification Renewal & Re-Takes
- Special Request Workshops
- 2024 Certification Weeks
- Plant Certification
- Find a Certification Plant

MEMBERSHIP

- Membership Benefits
- Antitrust
- Join PTI
- Membership Directory
- Tonnage Report
- Project Proposal

COMMITTEES

- Committee Directory
- Join a Committee
- Committee Resources

EVENTS

- PTI Convention
- PTI Committee Days
- World of Concrete

EDUCATION

- Design Seminars
- PTI Academy
- PT Project Database
- Technical Notes & FAQ

PUBLICATIONS

- PTI Store
- PTI *JOURNAL*
- Addenda and Errata

Get Connected
with **PTI**





"Thank you PTI Members!"

Gregory Hunsicker, PTI President

The Post-Tensioning Institute (PTI) is a nonprofit organization for the advancement of post-tensioned, prestressed concrete design and construction. PTI represents a community of businesses and professionals dedicated to expanding quality post-tensioning applications.

Our Mission

PTI will promote and advance the post-tensioning industry through education and technical leadership.

Our Vision

PTI envisions a future in which post-tensioning is the first choice for reinforcing all structures.

+1 (248) 848-3180
info@post-tensioning.org

38800 Country Club Drive, Farmington Hills, MI 48331
www.post-tensioning.org